

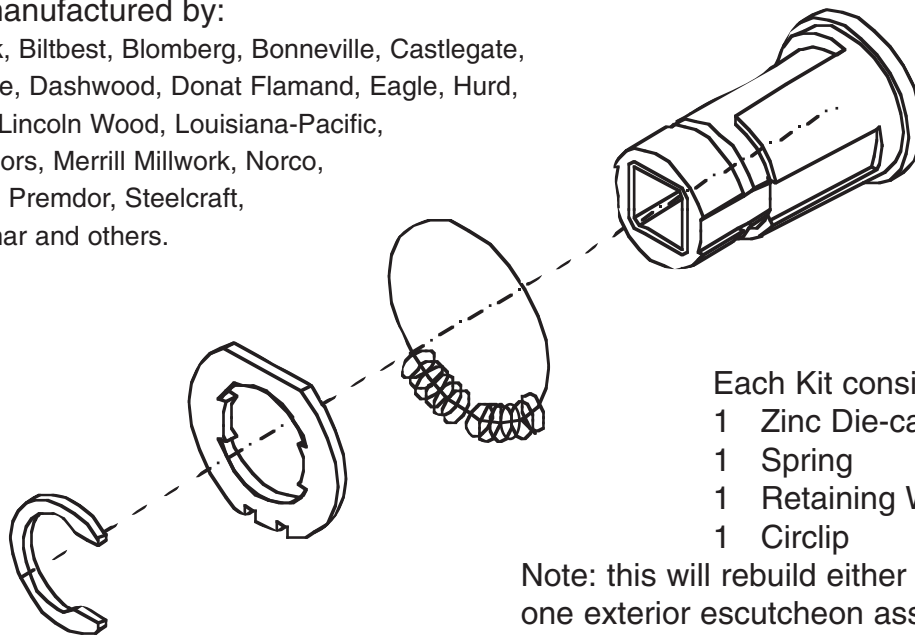

**1200-8-1000**  
**Bushing**  
**Replacement Kit**

This is a metal bushing assembly which will replace either the plastic or metal part and fits doors manufactured by:

Bend Millwork, Biltbest, Blomberg, Bonneville, Castlegate, Ceco, Craftline, Dashwood, Donat Flamand, Eagle, Hurd, Kolbe-Kolbe, Lincoln Wood, Louisiana-Pacific, Peachtree Doors, Merrill Millwork, Norco, Pease, Pozzi, Premdor, Steelcraft, Temple, Willmar and others.



Each Kit consists of:

- 1 Zinc Die-cast Bushing
- 1 Spring
- 1 Retaining Washer
- 1 Circlip

Note: this will rebuild either one interior or one exterior escutcheon assembly. Two kits are required to rebuild the complete door handle assembly.

**US \$12.00 each**

plus Shipping and Handling:

	First Kit	Additional Kits
UPS Ground	\$10.00	\$6.00 ea
UPS 2nd Day Air	\$20.50	\$13.00 ea
UPS Next Day Air	\$40.50	\$21.00 ea

(within the Continental US)

CA residents please add 8.25% tax.

Email, Fax or Call for shipment costs to other countries.

**ORDER FORM**

Quantity: \_\_\_\_\_ at \$12.00 ea = \$ \_\_\_\_\_

Shipping and handling: \$ \_\_\_\_\_

Shipping Method \_\_\_\_\_

Total Enclosed: \$ \_\_\_\_\_

Sorry, No Credit Cards... Mail this form with your check and fill in the Order Form above .  
 Orders normally ship within 24 hours.